

# the Astbury

LUXURY LODGES









## THE SAVANNAH

40 x 14 | 2 Bedroom

[theastbury.com](http://theastbury.com)



### WHY CHOOSE THE ASTBURY?

-  First-class Shropshire countryside location
-  Beautifully manicured grounds with panoramic views
-  18-hole championship course & putting green
-  Golf retail shop for all your golf needs
-  Delicious dining at The Astbury Bar & Kitchen
-  Holiday whenever you want with no closed season
-  Excellent earning potential with buy-to-let
-  **COMING SOON** | Brand-new facilities including tennis courts

### THE ASTBURY STANDARD

- ★ Fully furnished with stunning interiors
- ★ High-quality integrated appliances
- ★ Premium smart TVs to lounge
- ★ Sumptuous branded bathrobes
- ★ Golf club storage
- ★ Manufacturer's warranty
- ★ Large, low maintenance decking
- ★ Delivery, siting and all utilities connected

ASK ABOUT OUR  
**PLATINUM PACKAGE**  
UPGRADE!

## WELCOME TO THE SAVANNAH

Redefining convention, the Savannah provides stylish design and a spacious interior that defies its size.

With a rare centre lounge and high vaulted ceilings, let the outdoors inside with two sets of sliding patio doors that offer panoramic valley views. Woodland themed, you'll enjoy soft creams, gentle greens, and aged oaks which complement the peaceful countryside that surrounds us, but you'll have every convenience of the modern world with a feature media wall.

The contemporary kitchen has every essential you could need for entertaining, including a unique feature worktop that drops down into a dining table and a full suite of integrated appliances – perfect for hosting.

With two spacious bedrooms at either end of this holiday home, each comes complete with built-in wardrobes and en-suite, so you'll have privacy and space for the whole family. Beautiful and contemporary, the Savannah is the perfect haven away from everyday life.



## KEY FEATURES OF THE SAVANNAH

- ✓ Modern, contemporary lounge
- ✓ Feature backboard with lighting and glass fireplace
- ✓ Colour co-ordinated soft furnishings
- ✓ Stunning open plan kitchen and dining area with ample storage
- ✓ High-quality integrated appliances
- ✓ Large family bathroom
- ✓ Shower en-suite to master bedroom

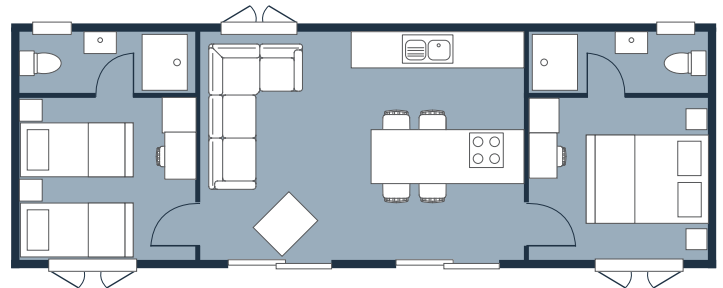

## THE ASTBURY LIFESTYLE

Set within the tranquil Shropshire countryside, our luxury lodges are nestled upon the gently sloping hillside above a beautiful winding river overhung by woodland. Designed by industry experts, every detail has been carefully thought out, down to the finest detail with each lodge sited on large, individual plots that offer stunning valley views and finished to only the highest of standards – there's no place more perfect to escape everyday life.



For more information, or to arrange your personal viewing appointment, please contact us on:



01746 331779



[lodges@theastbury.com](mailto:lodges@theastbury.com)

*Important notice: These particulars do not form part of any offer or contract and must not be relied upon as statements or representations of fact. Any areas, measurements or distances are approximate. The text, photographs and plans are for guidance only and are not necessarily comprehensive.*

*All accommodation at The Astbury is sold for HOLIDAY USE ONLY and must not be used as a primary place of residence. Evidence of a permanent address is required before purchasing and on-going annual checks of your permanent home address are a compulsory requirement of ownership.*