

the
Astbury
— LUXURY LODGES

THE CASA DI LUSSO

45 X 22 | 2 & 3 Bedroom

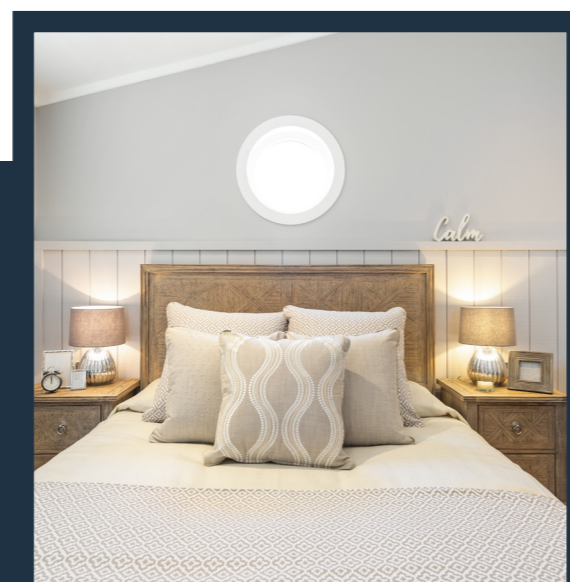



WELCOME TO THE CASA DI LUSSO

Literally translated as “The House of Luxury”, you can be certain that the Casa Di Lusso is something special. With a striking split-level roofline, this lodge has been specifically designed to be as relaxing as possible – lustrous fabrics in neutral tones and a crackling corner fireplace invite a feeling of warmth and charm to the main living space.

Upon entering, you’ll catch a glimpse of the whitewashed rough sawn timber walls through the stylish brise-soleil partition. Floor to ceiling cathedral style windows allow an abundance of light to stream through the open plan layout to highlight the modern, fully equipped kitchen that comes complete with island breakfast bar.

The master bedroom boasts a large king-size bed, offset by a large shower en-suite and walkthrough wardrobe and the generously sized second bedroom is perfect for family and guests, offering flexibility as either a double bed or twin single beds thanks to a clever zip & link mattress.

Classic and timeless, the Casa Di Lusso is one lodge you’ll never want to leave

WHY CHOOSE THE ASTBURY?

-  First-class location in the heart of Shropshire countryside
-  Beautifully manicured grounds with panoramic views
-  18-hole championship course & putting green
-  Golf retail shop for all your golf needs
-  Delicious dining at The Astbury Bar & Kitchen
-  Holiday whenever you want with no closed season
-  Excellent earning potential with buy-to-let
-  **COMING SOON** | Brand-new facilities including tennis courts

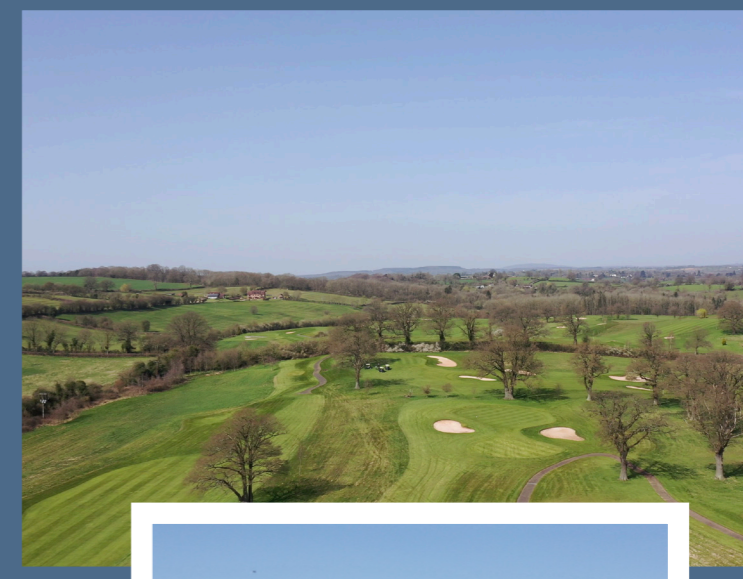

ASK ABOUT OUR PLATINUM PACKAGE UPGRADE!

THE ASTBURY STANDARD

- ★ Fully furnished with stunning interiors
- ★ High-quality integrated appliances
- ★ Premium smart TVs to lounge
- ★ Sumptuous branded bathrobes
- ★ Golf club storage
- ★ Manufacturer’s warranty
- ★ Large, low maintenance decking
- ★ Delivery, siting and all utilities connected

KEY FEATURES OF THE CASA DI LUSSO

- ✓ Architectural designed split-level roof line
- ✓ Cathedral style front elevation with French doors
- ✓ Rough sawn timber feature wall and freestanding electric fireplace
- ✓ Shaker style kitchen with island breakfast bar
- ✓ Integrated appliances incl. five-burner gas hob, oven, microwave, dishwasher, American fridge/freezer, washer/dryer & wine cooler
- ✓ Shower en-suite to master bedroom
- ✓ Cabin beds and feature porthole windows to second bedroom

BENEFITS OF OWNERSHIP

- ✓ Simple, turnkey holiday home ownership
- ✓ No stamp duty to pay
- ✓ No legal fees to pay
- ✓ Fully managed sublet service
- ✓ Holiday any time of year with no closed season

The Casa Di Lusso
45 x 22 | 2 Bedroom

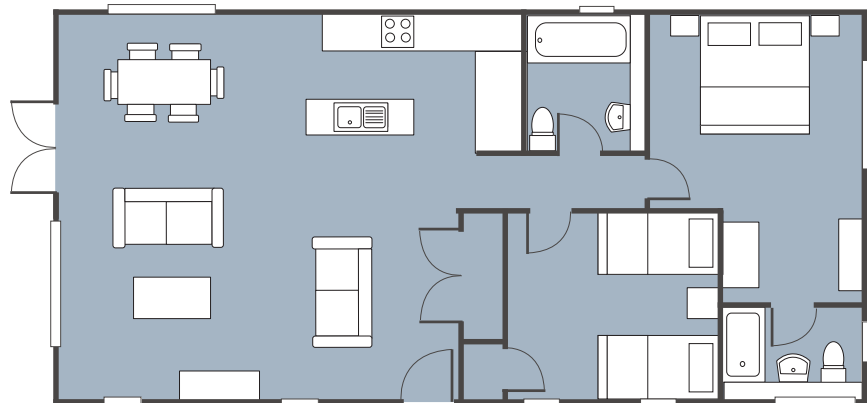

The Casa Di Lusso
45 x 22 | 3 Bedroom

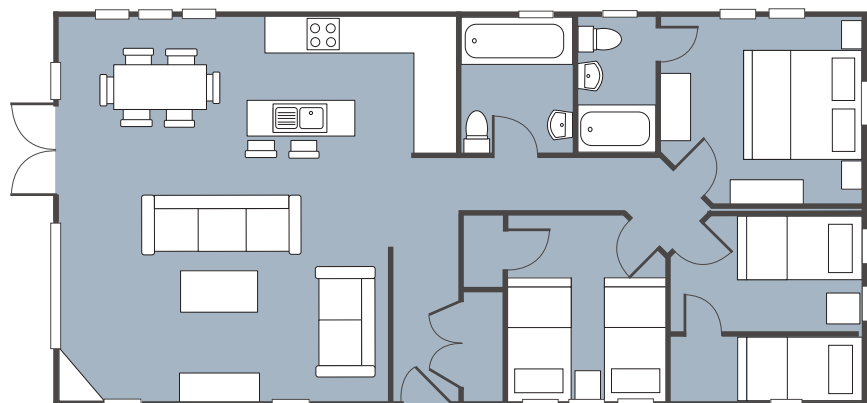

For more information, or to arrange your personal viewing appointment, please contact us on:



01746 331777



lodges@theastbury.com

Important notice: These particulars do not form part of any offer or contract and must not be relied upon as statements or representations of fact. Any areas, measurements or distances are approximate. The text, photographs and plans are for guidance only and are not necessarily comprehensive.

All accommodation at The Astbury is sold for HOLIDAY USE ONLY and must not be used as a primary place of residence. Evidence of a permanent address is required before purchasing and on-going annual checks of your permanent home address are a compulsory requirement of ownership.